

**vtech**<sup>®</sup>

Instruction Manual

## Wind & Go Turtle



91-004002-000 

VTech understands that a child's needs and abilities change as they grow and with that in mind we develop our toys to teach and entertain at just the right level...

### **vtech** Baby

Toys that will stimulate their interest in different textures, sounds and colours

#### I am...

...responding to colours, sounds and textures

...understanding cause and effect

...learning to touch, reach, grasp, sit-up, crawl and toddle

Birth-36 months



### **Pre-School**

Interactive toys to develop their imagination and encourage language development

#### I want...

...to get ready for school by starting to learn the alphabet and counting

...my learning to be as fun, easy and exciting as can be

...to show my creativity with drawing and music so my whole brain develops

3-6 years



### **Electronic Learning Computers**

Cool, aspirational and inspiring computers for curriculum related learning

#### I need...

...challenging activities that can keep pace with my growing mind

...intelligent technology that adapts to my level of learning

...National Curriculum based content to support what I'm learning at school

4-10 years



To learn more about this and other VTech® products, visit [www.vtech.co.uk](http://www.vtech.co.uk)

# INTRODUCTION

Bath time becomes fun time with the **Wind & Go Turtle** by **VTech!** Pull the little baby turtle to wind the toy up & watch the two turtles swim in a circle! Press the light up heart button to trigger encouraging phrases, sing-along songs and melodies. Let's explore & discover!

## INCLUDED IN THIS PACKAGE

- Wind & Go Turtle learning toy
- Instruction Manual

### WARNING:

All packing materials such as tape, plastic sheets, packaging locks, removable tags, cable ties, cords and packaging screws are not part of this toy and should be discarded for your child's safety.

**NOTE:** Please save this Instruction Manual as it contains important information.

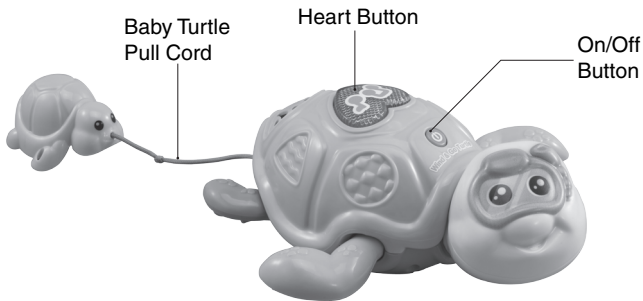

# INSTRUCTIONS

## BATTERY REMOVAL AND INSTALLATION

1. Make sure the unit is turned **OFF**.
2. Locate the battery cover on the bottom of the unit. Use a screwdriver to loosen the screw.
3. If used batteries are present, remove these batteries from the unit by pulling up on one end of each battery.
4. Install 1 new AAA (AM-4/LR03) battery following the diagram inside the battery box. (The use of new alkaline batteries is recommended for maximum performance.)
5. Replace the battery cover and tighten the screw to secure.

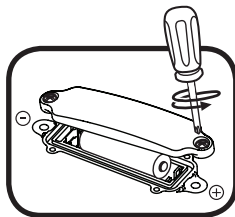

**WARNING:** Adult assembly required for battery installation. Keep batteries out of reach of children.

### Removing the packaging locks

- ① Rotate the packaging lock anticlockwise several times.
- ② Pull out the packaging lock and discard.

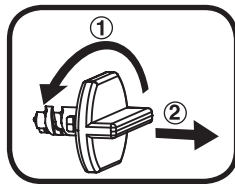

## IMPORTANT: BATTERY INFORMATION

- Insert batteries with the correct polarity (+ and -).
- Do not mix old and new batteries.
- Do not mix alkaline, standard (carbon-zinc) or rechargeable batteries.
- Only batteries of the same or equivalent type as recommended are to be used.
- Do not short-circuit the supply terminals.
- Remove batteries during long periods of non-use.
- Remove exhausted batteries from the toy.
- Dispose of batteries safely. Do not dispose of batteries in fire.

### RECHARGEABLE BATTERIES:

- Remove rechargeable batteries from the toy before charging.
- Rechargeable batteries are only to be charged under adult supervision.
- Do not charge non-rechargeable batteries.

With the **VTech® Wind & Go Turtle**, safety comes first. To ensure your child's safety, please ensure the battery cover is securely locked into position to avoid injury.

## Disposal of batteries and product



The crossed-out wheellie bin symbols on products and batteries, or on their respective packaging, indicates they must not be disposed of in domestic waste as they contain substances that can be damaging to the environment and human health.



The chemical symbols Hg, Cd or Pb, where marked, indicate that the battery contains more than the specified value of mercury (Hg), cadmium (Cd) or lead (Pb) set out in Battery Directive (2006/66/EC).

The solid bar indicates that the product was placed on the market after 13th August, 2005.

Help protect the environment by disposing of your product or batteries responsibly.

VTech® cares for the planet.

Care for the environment and give your toy a second life by disposing of it at a small electricals collection point so all its materials can be recycled.

In the UK:

Visit [www.recyclenow.com](http://www.recyclenow.com) to see a list of collection points near you.

In Australia & New Zealand:

Check with you local council for kerbside collections.

## PRODUCT FEATURES

### 1. On/Off Button

Press and hold the **On/Off button** to turn the unit On, Press and hold the **On/Off button** to turn the unit Off.



### 2. Automatic Shut-Off

To preserve battery life, the Wind & Go Turtle will automatically power down after approximately 43 seconds without input. The unit can be turned on again by pressing the **On/Off Button**, **Heart Button** or pulling **Baby Turtle Pull Cord**.

**NOTE:** The speaker must be kept above water. If the speaker fills up with water, remove the turtle from the water as soon as possible and allow the water to drain away from the speaker.

## WARNINGS:

- The batteries must be changed by an adult.
- This toy cannot be used in salt water.
- After using this toy, do not leave it in the water for a long time.
- Make sure to empty the water out of all elements of the toy and to rinse them out before drying.
- This toy can be operated in water only when fully assembled in accordance with the instructions.
- This is not a lifesaving device. Do not leave your child unattended while this **VTech® Wind & Go Turtle** unit is in use.

- Never leave a child unattended or with an older child in the bathroom or in the bath, not even for one minute.
- Always check with a thermometer the temperature of the water coming from the tap before sitting your child in the bath. Toddlers have very sensitive skin and can easily get burnt if the water is too hot.
- When closing the battery cover ensure that the screw is securely tightened. This will avoid any water leakage.
- Only use this unit in water between 10 and 45 degrees centigrade.
- Parents should drain the water from the speaker if the volume decreases too much.

## ACTIVITIES

### 1. On/Off Button

Press and hold the **On/Off button** to turn the unit **On**, You will hear a song, two fun phrases, a short tune and a playful sound. Press and hold the **On/Off button** to turn the unit **Off**, You will hear a short tune. The light will flash with the sounds.



### 2. Heart Button

Press the **Heart Button** to hear fun sing along songs, a short tune, phrases and melodies. When a melody is playing, pull the **Baby Turtle Pull Cord**, fun phrases about swimming and bathing will play on top of the melody. The light will flash with the sounds.

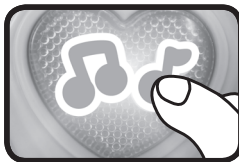

### 3. Baby Turtle Pull Cord

Pull back the little baby turtle to see Mummy turtle and baby turtle swim in a circle and play a variety of fun phrases and sounds. The light will flash with the sounds.

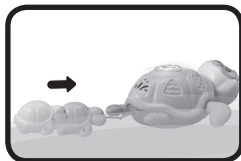

## MELODY LIST

1. Aiken Drum
2. A-Tisket A-Tasket
3. Bicycle Built for Two
4. Blue Danube Waltz
5. Cockles and Mussels
6. Green Grass Grew All Around
7. Hickory Dickory Dock
8. Hot Cross Buns
9. Little Miss Muffet
10. Mary Had a Little Lamb
11. Pat-A-Cake
12. Row, Row, Row Your Boat
13. Skip to My Lou
14. Three Little Kittens
15. Yankee Doodle

## SONG LYRICS

Song 1

Hello little swimmer, are you ready?  
Come to play with my baby and me

Song 2

Bath time, happy time,  
Follow my little baby,  
Take a bath,



Clean your body,  
From head to toe.

Song 3

My flippers move back and forth,  
Swimming is so much fun!  
We'll swim, we'll float, we'll dive all around  
splashing as we go!

## CARE & MAINTENANCE

1. Keep the unit clean by wiping it with a slightly damp cloth.
2. Keep the unit out of direct sunlight and away from any direct heat source.
3. Remove the batteries when the unit is not in use for an extended period of time.
4. Do not drop the unit on hard surfaces and do not expose the unit to moisture or water.

## TROUBLESHOOTING

If for some reason the unit stops working or malfunctions, please follow these steps:

1. Turn the unit **OFF**.
2. Interrupt the power supply by removing the batteries.
3. Let the unit stand for a few minutes, then replace the batteries.
4. Turn the unit **ON**. The unit should now be ready to play with again.
5. If the product still does not work, install a new set of batteries.

If the problem persists, please contact our Consumer Services Department and a service representative will be happy to help you.

## CONSUMER SERVICES

Creating and developing **VTech**<sup>®</sup> products is accompanied by a responsibility that we at **VTech**<sup>®</sup> take very seriously. We make every effort to ensure the accuracy of the information, which forms the value of our products. However, errors sometimes can occur. It is important for you to know that we stand behind our products and encourage you to call our Consumer Services Department with any problems and/or suggestions that you might have. A service representative will be happy to help you.

### **UK Customers:**

Phone: 0330 678 0149 (from UK) or +44 330 678 0149 (outside UK)

Website: [www.vtech.co.uk/support](http://www.vtech.co.uk/support)

### **Australian Customers:**

Phone: 1800 862 155

Website: [support.vtech.com.au](http://support.vtech.com.au)

### **NZ Customers:**

Phone: 0800 400 785

Website: [support.vtech.com.au](http://support.vtech.com.au)

## Product Warranty /Consumer Guarantees

UK Customers:

Read our complete warranty policy online at [vtech.co.uk/warranty](http://vtech.co.uk/warranty).

Australian Customers:

**VTECH ELECTRONICS (AUSTRALIA) PTY LIMITED – CONSUMER GUARANTEES**

Under the Australian Consumer Law, a number of consumer guarantees apply to goods and services supplied by VTech Electronics (Australia) Pty Limited. Please refer to [vtech.com.au/consumerguarantees](http://vtech.com.au/consumerguarantees) for further information.



**Visit our website for more  
information about our products,  
downloads, resources and more.**

***[www.vtech.co.uk](http://www.vtech.co.uk)***  
***[www.vtech.com.au](http://www.vtech.com.au)***



TM & © 2021 VTech Holdings Limited.  
All rights reserved.  
**Printed in China.**  
91-004002-000 ©